



REHAU®

Unlimited Polymer Solutions



INDUSTRIAL HOSES AND ACCESSORIES

THE RIGHT WAY TO GO

CONTENTS

RAUFILAM®-E	4
RAUFILAM SOFT	5
COMPLETE SET OF COMPONENT PARTS	6
INDUSTRIAL HOSES	7
RAUCLAIR®-E	8

RAUFILAM®-E

FIBRE REINFORCED, PRESSURE-RESISTANT AND CADMIUM-FREE FOOD GRADE HOSES HAVING UNDERGONE TYPE APPROVAL ACC. TO GERMAN KTW STANDARDS FOR DRINKING WATER HOSES

Proven quality

For RAUFILAM-E hoses, selected raw materials are used and manufactured using special REHAU production processes. The result – hoses which set quality standards due to their outstanding properties.

RAUFILAM-E hoses have undergone a type approval test by the TÜV Product-Service (Technical Inspectorate) verifying that REHAU quality standards are confirmed by an independent body.

RAUFILAM-E benefits:

- lasting transparency
- attractive colours
- extraordinary flexibility
- high resistance to chemicals (refer to material datasheet RAU-PVC; AV 0010)
- outstanding age resistance
- excellent abrasion resistance
- environmentally friendly, cadmium-free material
- good reinforcement
- approval acc. to German regulations for drinking water hoses

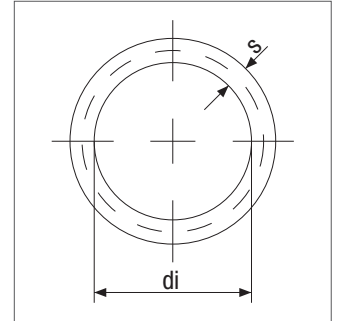
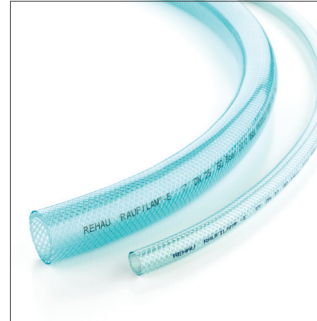

Material and colour:

Inside: RAU-PVC 7806, 70002 crystal clear

Outside: RAU-PVC 7806, 29101 transparent

The brand name, size and operating pressure are printed on the hose to show its classification, making it easier to use.

Article	Var.	Designation	Size ¹ di/s mm	Permissible operating pressure ² at			Bending radius mm (at 20 °C)	Coil length	EAN code
				20 °C	40 °C	60 °C			
028511	002	DN 4	4/3	23	18	14	15	50 m	40 07360 187644
028531	002	DN 6	6/3	20	16	12	25	50 m	40 07360 187682
028551	002	DN 8	8/3	18	15	11	30	50 m	40 07360 187736
028561	002	DN 9	9/3	16	13	10	35	50 m	40 07360 187620
028571	002	DN 10	10/3	14	12	9	40	50 m	40 07360 187781
028581	002	DN 12	12/3	14	12	9	55	50 m	40 07360 187811
028591	002	DN 12	12.2/4.2	14	12	9	50	50 m	40 07360 187842
028601	002	DN 13	13.2/3.3	12	9	7	70	50 m	40 07360 187866
028621	001	DN 16	16.2/3.7	12	9	7	90	25 m	40 07360 187897
028621	002	DN 16	16.2/3.7	12	9	7	90	50 m	40 07360 187903
028631	001	DN 19	19.4/3.7	10	8	6	130	25 m	40 07360 187927
028631	002	DN 19	19.4/3.7	10	8	6	130	50 m	40 07360 187934
028651	001	DN 25	25.4/4.3	8	7	6	200	25 m	40 07360 187972
028651	002	DN 25	25.4/4.3	8	7	6	200	50 m	40 07360 187989
028671	001	DN 32	32.4/4.8	7	6	5	310	25 m	40 07360 188016
028681	001	DN 38	38/4.8	6	5	4	420	25 m	40 07360 188023
028691	001	DN 40	40/4.5	6	5	4	460	25 m	40 07360 188030
028701	001	DN 50	50/5	4	3	2	650	25 m	40 07360 188047
028711	001	DN 50	50/6	4	3	2	620	25 m	40 07360 188054

¹ Tolerances: inner diameter
 up to 5 mm: + 0.1 mm/ - 0.2 mm
 over 5 - 8 mm: + 0.2 - 0.3 mm
 over 8 mm: + 2.5 % - 3 %
 wall thickness: ± 10 %

² The operating pressures given were established in burst pressure tests along the lines of DIN 20024 with a safety factor of 4.

Further sizes and hose types are available on request.

RAUFILAM SOFT

CHARACTERISED BY EXTRAORDINARY FLEXIBILITY

The materials used for RAUFILAM Soft hoses result in an extraordinary flexibility even at low temperatures. Thus, handling of the hoses is considerably improved. Therefore the use of RAUFILAM Soft in pneumatic tools for indoor and outdoor application is of particular interest.

Application:

- Compressed air supply for pneumatic tools
- Fixed or movable winding devices for compressed air supply

Used in:

- Assembly plants
- Commercial garages (cars/ commercial vehicles)
- Joiner's workshops

Material:

RAU-PVC 7008/6558

Colour:

Black/blue

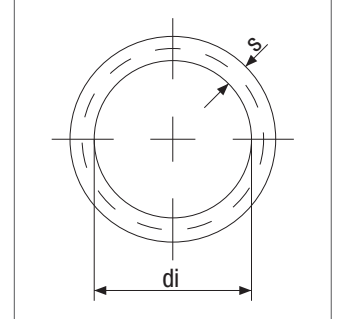
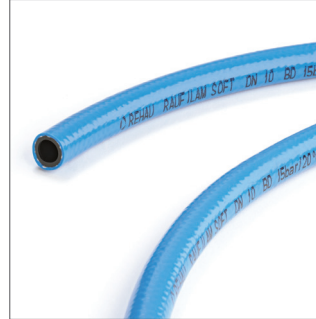

Article	Var.	Designation	Size di/s mm	Permissible operating pressure in bar at 20°	Coil length	EAN code
028186	001	DN 6	6/2.5 mm	15	50 m	4007360344788
028196	001	DN 8	8/2.5 mm	15	50 m	4007360344795
028206	001	DN 9	9/2.8 mm	15	50 m	4007360344801
028216	001	DN 10	10/3 mm	15	50 m	4007360344818
028226	001	DN 13	12.7/3 mm	15	50 m	4007360344825

COMPLETE SET OF COMPONENT PARTS:

REHAU COMPRESSED AIR FITTINGS

The fibre reinforced RAUFILAM hose is available as a complete set (with fittings) and equipped with high quality compressed air brass fittings.

REHAU compressed air fittings are particularly suitable for the following applications:

- Commercial garages
- Construction sites
- DIY

Compressed air fittings are available in three lengths (5 m, 10 m, 15 m), each in size DN 6 and DN 9, and resist to an operating pressure of 20 bar (DN 6) and 16 bar (DN 9) respectively.

Benefits

The robust construction of compressed air fittings which consist of stainless steel component parts as well as of tempered locking pins and combined with high quality gaskets, ensure safe and easy operation, even in continuous application.



Article	Var.	Size	Operating pressure 20 °C	Make-up	EAN code
090406	002	DN 6	20 bar	5 m	40 07360 191061
090416	002	DN 6	20 bar	10 m	40 07360 191078
090426	002	DN 6	20 bar	15 m	40 07360 191085
090436	002	DN 9	16 bar	5 m	40 07360 191092
090446	002	DN 9	16 bar	10 m	40 07360 191108
090456	002	DN 9	16 bar	15 m	40 07360 191115

INDUSTRIAL HOSES

FIBRE REINFORCED, TRANSPARENT AND COLOURED

Fibre reinforced, coloured industrial hoses made by REHAU are suitable for the transport of various media such as technical gases or liquids.

They are available in three attractive, transparent colours:

- red
- blue
- green

Our fibre reinforced industrial hoses which are made of excellent cadmium-free material, can be delivered in size DN 6, 8, 9, 10 and DN 13.

Effective due to being:

- abrasion resistant
- age resistant
- chemical resistant
- cadmium-free
- transparent

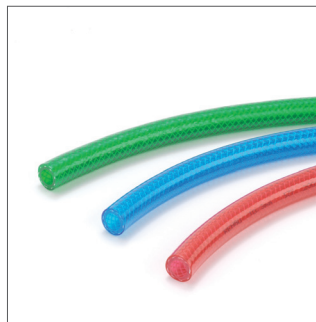

Article	Var.	Size	Colour	Operating pressure 20 °C	Bending radius mm (at 20 °C)	Coil length	EAN code
249313	001	DN 6	transparent red	15 bar	25	50 m	40 07360 109738
249313	002	DN 6	transparent blue	15 bar	25	50 m	40 07360 109745
249313	003	DN 6	transparent green	15 bar	25	50 m	40 07360 109752
249323	001	DN 8	transparent red	15 bar	30	50 m	40 07360 109769
249323	002	DN 8	transparent blue	15 bar	30	50 m	40 07360 109776
249323	003	DN 8	transparent green	15 bar	30	50 m	40 07360 109783
249333	001	DN 9	transparent red	12 bar	35	50 m	40 07360 109790
249333	002	DN 9	transparent blue	12 bar	35	50 m	40 07360 109806
249333	003	DN 9	transparent green	12 bar	35	50 m	40 07360 109813
249343	001	DN 10	transparent red	10 bar	40	50 m	40 07360 109820
249343	002	DN 10	transparent blue	10 bar	40	50 m	40 07360 109837
249343	003	DN 10	transparent green	10 bar	40	50 m	40 07360 109844
249353	001	DN 13	transparent red	10 bar	70	50 m	40 07360 109851
249353	002	DN 13	transparent blue	10 bar	70	50 m	40 07360 109868
249353	003	DN 13	transparent green	10 bar	70	50 m	40 07360 109875

RAUCLAIR®-E

CRYSTAL CLEAR, CADMIUM-FREE HOSES, APPROVED ACC. TO GERMAN KTW STANDARDS FOR DRINKING WATER HOSES

RAUCLAIR-E is manufactured from environmentally friendly cadmium-free material. Due to its chemical resistance, high flexibility and crystal clear transparency, it is suitable for the following applications:

- in the laboratory as it is resistant to acids and alkalis
- in mechanical engineering as it is permanently flexible and resistant to abrasion
- in measurement and control technology as the transparency allows for reliable visual monitoring.

For all the other applications where the flow of liquid or gaseous media is monitored, the age resistant RAUCLAIR-E hose is the right way to go.

RAUCLAIR-E hoses are unmistakable as they are marked with brand name, reference to food grade and size.

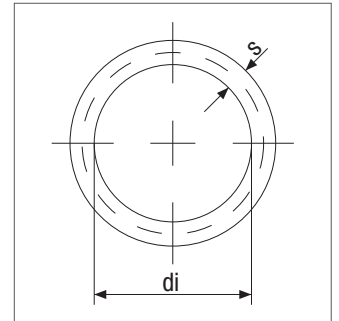

RAUCLAIR-E hoses have been approved acc. to German KTW standards for drinking water hoses.

Article	Var.	Size di/s mm	Coil length	Packaging unit coils/box	EAN code
030390	003	2/1	100 m	12	40 07360 036829
030180	003	3/1	100 m	8	40 07360 036836
030230	003	3/1.5	100 m	8	40 07360 036843
030030	004	4/1	100 m	8	40 07360 036850
030370	003	4/1.5	100 m	5	40 07360 036867
030380	003	4/2	100 m	5	40 07360 036874
030460	002	5/1	100 m	6	40 07360 036881
030440	006	5/1.5	100 m	5	40 07360 036898
030399	002	5/2	100 m	4	40 07360 036904
030490	003	6/1	100 m	6	40 07360 036911
030500	006	6/1.5	100 m	4	40 07360 036928
030510	003	6/2	100 m	3	40 07360 036935
030570	005	7/1.5	100 m	3	40 07360 036942
030580	005	7/2	100 m	3	40 07360 036959
030610	003	8/1.5	50 m	4	40 07360 036966
030620	005	8/2	50 m	4	40 07360 036980
030650	004	9/1.5	50 m	5	40 07360 036997
030660	002	9/2	50 m	4	40 07360 037000
030540	003	10/1.5	50 m	4	40 07360 037017
030700	008	10/2	50 m	3	40 07360 037024
030720	007	10/3	50 m	3	40 07360 037031
030409	002	12/1.5	50 m	3	40 07360 037048
030780	007	12/2	50 m	3	40 07360 037055
030190	003	12/3	50 m	2	40 07360 037079

Article	Var.	Size di/s mm	Coil length	Packaging unit coils/box	EAN code
030850	003	13/3	50 m	2	40 07360 037086
030020	002	14/2	50 m	2	40 07360 037093
030120	003	15/2	50 m	2	40 07360 037109
030220	003	16/2	50 m	single coil	40 07360 037123
030179	006	16/2.5	50 m	single coil	40 07360 037130
031210	003	18/3	50 m	single coil	40 07360 037154
033600	002	19/2	50 m	single coil	40 07360 037161
031990	005	19/3	50 m	single coil	40 07360 037178
030240	006	19/3.5	50 m	single coil	40 07360 037192
031020	002	19/4	50 m	single coil	40 07360 037208
030919	002	20/2	50 m	single coil	40 07360 037215
030260	003	20/3	50 m	single coil	40 07360 037222
030449	002	22/3	50 m	single coil	40 07360 037239
033290	003	25/3	50 m	single coil	40 07360 037246
030280	007	25/4	50 m	single coil	40 07360 037277
030290	002	27/3	25 m	single coil	40 07360 037284
030459	002	30/4	25 m	single coil	40 07360 037291
030239	004	32/4	25 m	single coil	40 07360 037321
031009	001	35/3.5	25 m	single coil	40 07360 037345
032710	003	38/5	25 m	single coil	40 07360 037352
031500	002	40/5	25 m	single coil	40 07360 037369
032680	003	50/5	25 m	single coil	40 07360 037383
032690	002	60/5	25 m	single coil	40 07360 037390

Only for non-pressurised applications.

This document is protected by copyright. All rights based on this are reserved. No part of this publication may be translated, reproduced or transmitted in any form or by any similar means, electronic or mechanical, photocopying, recording or otherwise, or stored in a data retrieval system.

Our verbal and written advice relating to technical applications is based on experience and is to the best of our knowledge correct but is given without obligation.

The use of REHAU products in conditions that are beyond our control or for applications other than those specified releases us from any obligation in regard to claims made in respect of the products.

We recommend that the suitability of any REHAU product for the intended application should be checked. Utilization and processing of our products are beyond our control and are therefore exclusively your responsibility. In the event that a liability is nevertheless considered, any compensation will be limited to the value of the goods supplied by us and used by you.

Our warranty assumes consistent quality of our products in accordance with our specification and in accordance with our general conditions of sale.

REHAU SALES OFFICES

AUS: Adelaide, Tel.: +61 8 82990031, adelaide@rehau.com **Brisbane**, Tel.: +61 7 38897522, brisbane@rehau.com **Melbourne**, Tel.: +61 3 95875544, melbourne@rehau.com **Perth**, +61 8 4564311, perth@rehau.com **Sydney**, Tel.: +61 2 87414500, sydney@rehau.com **CDN: Moncton**, Tel.: +1 506 5382346, moncton@rehau.com **Montreal**, Tel.: +1 514 9050345, montreal@rehau.com **St. John's**, Tel.: +1 709 7473909, stjohns@rehau.com **Toronto**, Tel.: +1 905 3353284, toronto@rehau.com **Vancouver**, Tel.: +1 604 6264666, vancouver@rehau.com **Winnipeg**, Tel.: +1 204 6972028, winnipeg@rehau.com **GB: Birmingham**, Tel.: +44 121 3442-300, birmingham@rehau.com **Glasgow**, Tel.: +44 1698 503 700, glasgow@rehau.com **Manchester**, Tel.: +44 161 7777-400, manchester@rehau.com **Slough**, Tel.: +44 1753 5885-00, slough@rehau.com **HK: Hongkong**, Tel.: +8 52 28987080, hongkong@rehau.com **IRL: Dublin**, Tel.: +353 1 816502-0, dublin@rehau.com **NZ: Auckland**, Tel.: +649 2722264, auckland@rehau.com **SGP: Singapore**, Tel.: +65 63926006, singapore@rehau.com **USA: Chicago**, Tel.: +1 630 3173500, chicago@rehau.com **Dallas**, Tel.: +1 972 2702322, dallas@rehau.com **Detroit**, Tel.: +1 248 8489100, detroit@rehau.com **Grand Rapids**, Tel.: +1 616 2856867, grandrapids@rehau.com **Greensboro**, Tel.: +1 336 8522023, greensboro@rehau.com **Los Angeles**, Tel.: +1 951 5499017, losangeles@rehau.com **Minneapolis**, Tel.: +1 763 5851380, minneapolis@rehau.com **ZA: Durban**, Tel.: +27 31 657447, durban@rehau.com, **Johannesburg**, Tel.: +27 11 2011300, johannesburg@rehau.com