



PROFILES FOR SHOWER PARTITIONS

PROFILE PRINT D55100EN

TABLE OF CONTENTS

1	General information	P. 3	2.6	Other profiles	P. 21
2	Profiles	P. 5	2.6.1	Adapter profiles	P. 21
2.1	Sealing profiles in RAU-PVC -			for beveled glass	P. 21
	crystal clear colour matching (rigid-PVC)	P. 5		for unbeveled glass	P. 21
2.1.1	Profiles with 5 mm overlap for 5 mm thick glass	P. 5	2.6.2	Strip seals in RAU-PVC	P. 21
2.1.2	Profiles with 5 mm overlap for 6 mm thick glass	P. 6	2.6.3	Door seal profiles for insertion in aluminium strips	P. 22
2.1.3	Profiles with 5 mm overlap for 8 mm thick glass	P. 6		in RAU-PVC	P. 22
2.1.4	Profiles with 12 mm overlap for 5 mm thick glass	P. 8		in RAU-SIK	P. 22
2.1.5	Profiles with 12 mm overlap for 6 and 8 mm thick		2.6.4	Sealing profiles in RAU-SIK	P. 22
	glass	P. 9	2.6.5	Hinge profiles in RAU-PVC	P. 22
2.2	Sealing profiles in RAU-PVC - usual transparent		2.6.6	Shock damping profiles in RAU-PVC / RAU-SB /	
	colour matching (rigid-PVC)	P. 11		RAU-SRT	P. 23
2.2.1	Profiles for 6 and 8 mm thick glass	P. 11	2.6.7	Cover profiles	P. 23
2.2.2	Profiles for 6 and 8 mm thick glass - chrome	P. 11		in RAU-rigid PVC	P. 23
2.2.3	Profiles for 8 and 10 mm thick glass	P. 12		in RAU-rigid/soft PVC	P. 23
2.2.4	Profiles for other thicknesses	P. 13	3	List of articles	P. 24
2.3	Slide-in profiles for insertion into aluminium strips	P. 14			
2.3.1	in RAU-PVC	P. 14			
2.3.2	in RAU-SRT	P. 14			
2.4	Glazing profiles	P. 15			
2.4.1	in RAU-PVC / RAU-PE	P. 15			
2.4.2	in RAU-SIK	P. 15			
2.5	Magnetic profiles in RAU-FER	P. 16			
2.5.1	Magnetic strips	P. 16			
2.5.2	Coated magnetic strips	P. 17			
2.5.3	Magnetic strips with self-adhesive strip	P. 17			
2.5.4	T-magnets	P. 18			
2.5.5	Hat magnets	P. 18			
2.5.6	Stepped magnets	P. 19			
2.5.7	Special magnetic profiles	P. 20			

1 GENERAL INFORMATION

Applications

Because of their high quality material formulation, especially aligned with your installation system, REHAU shower partition seal profiles are suitable for use in a wide variety of shower partition seal systems, for example

- all-glass shower cubicle
- framework shower cubicles
- bath fixtures
- other types of partitions



Photograph supplied by courtesy of Kermi



Material

REHAU, as an innovative processor of polymer materials, constantly faces up to the demands of the market. Our specialists in matters of materials science are working continually on the further development of our material formulations.

Designation of material types:

The designations of material types provide information about the origin of REHAU (RAU), about the raw material (using the plastics abbreviations in general according to DIN 7728) and in the two to four-digit coding scheme about certain material properties.

The coding scheme with RAU-PVC is always four-digit. Numbers between 1100 and 1999 stand for rigid PVC, numbers between 3000 and 9999 for PVC containing plasticiser, whereby the first two figures show the hardness in Shore A.

REHAU rigid/soft PVC (RAU-PVC)

Advantages offered by REHAU profiles in rigid/soft PVC:

- **UV resistance**
UV resistance is tested in REHAU using XENON TEST 1200, cycle 102/18, alternate cycling.
Laboratory result:
> 1,000 hrs until there is a noticeable change in colour!
- **Crystal clear colour matching (rigid PVC)**
The high-quality RAU-PVC1107 formulation in combination with an optimum tool design enables REHAU to manufacture the rigid PVC range in a unique crystal clear design (Profiles pages 5-10)
- **Acrylic tolerance**
Contact by those profiles made of soft PVC with acrylic, PS sheets etc can lead to stress cracking and hardening of soft PVCs. The use of RAU-PVC 7539 (acrylic resistant formulation) eliminates this chemical reaction.
So, for example, almost all water repellent profiles at REHAU are supplied using PVC 7539.
Testing is done following DIN 53405, which states that migration of plasticiser during the test period of 15 days, at 50°C with 5 kg loading may amount to max. 10 mg.
- **Mould has no chance**
The fungicide formulation of all our soft PVC materials used in the shower partition seal profiles prevents the growth of moulds. Laboratory test according to DIN 53739, process B/ISO B46 – 1978, combined with ASTM G 21-70.
- **Structured injection moulding of magnetic pockets**
The magnetic pockets of all door gasket profiles are injection moulded in a structured material grade (soft PVC). This counteracts the profiles sticking together and thus any impairment of the door seal
- **Structured soft lips**
Structured soft PVC lips improve the slide behaviour as regards the glass.

REHAU Silicone (RAU-SIK)

Long-lasting elasticity and recovery capacity are ensured through our own REHAU silicone formulations based on hot-cross-linked silicones. This prevents mould forming.

With glazing beads (profile brochure page 15) a thread is co-extruded in the bead profile to protect against excessive stretching.

REHAU ferrite (RAU-FER)

REHAU ferrite is a flexible polymer compound containing barium ferrite to make it magnetisable. The ferrite content gives the material a black-brown colour.

- Magnetic force:

The magnetic force of the magnetic profiles is measured with a gap of 0.4 mm against an iron counterweight and given in N/cm. With stepped magnets the measurement is made against an iron counterweight with the same stepped formation.

REHAU quality management

Quality is monitored in REHAU from the goods inwards inspection of raw material, through the control of the material values of the extruded profiles, to dispatch on the basis of the REHAU quality assurance system.

The REHAU QM system meets the requirements of the internationally recognised Norm ISO 9001. Regular inspection audits by the certifying company TÜV Süd Management Service GmbH ensure the ISO certificate is retained.

Delivery make-up

Depending on the type of product, profiles are supplied in:

- fabrication lengths (length tolerance normally +/- 10 mm)
- spools (magnetic tapes)

Other delivery arrangements are available on request.

Packaging

Normally profiles are supplied packed in cartons.

Soft PVC lips, which could be squashed during transport /storage, are protected in addition by using polystyrene strips and reinforced cardboard intermediate layers inserted sideways in the boxes. Special customer-specific packaging can be provided on request.

Customer-specific developments

This profile brochure shows the freely available REHAU programme for the shower partition seal profile. All profiles can be varied to be customer-specific for delivery make-up (delivery length) and colour, among other things.

Naturally you can also develop YOUR profile with REHAU:

constructed by us according to your ideas, putting into practice your knowledge and skills for meeting quite specific tasks. Whether simple or complex shapes, whether existing or specially formulated materials, REHAU makes its know-how, knowledge of materials and qualified in-house tool and die shop available to you.

Our service for you in practice is:

- applicational advice
- our own formulation for materials
- exact colour matching in the REHAU colour laboratory
- optimum tool design in our own tool and die shop
- QM system according to ISO 9001
- fabrication into components ready to be installed.

2.1 SEALING PROFILES IN RAU-PVC

CRYSTAL CLEAR COLOUR MATCHING (RIGID-PVC)

Rigid-PVC in crystal clear colour matching; soft PVC part with transparent textured or transparent clear surface, Shore A 75°, acrylic resistant if necessary;

Door seal profiles with magnetic inlay: Magnet pockets in solid colour or transparent textured material, soft PVC flexible bellows in transparent clear or transparent textured material, magnet 2-pole

2.1.1 Profiles with 5 mm overlap for 5 mm thick glass

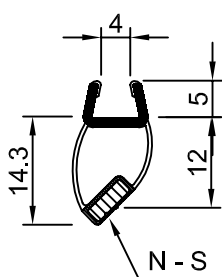

Art 655222
Magnetic strength 0.18 N/cm

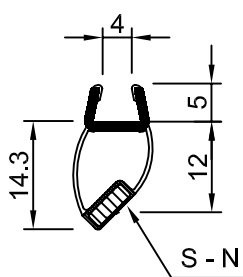

Art 655232
Magnetic strength 0.18 N/cm

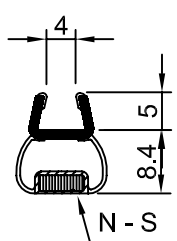

Art 655242
Magnetic strength 0.18 N/cm

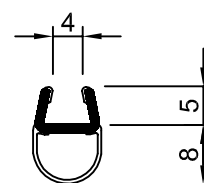

Art 655705

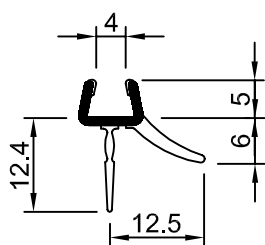

Art 655715

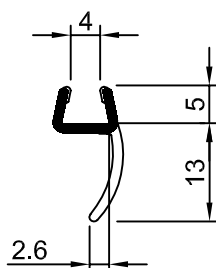

Art 655725

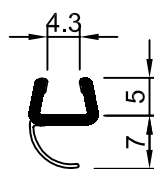

Art 655735

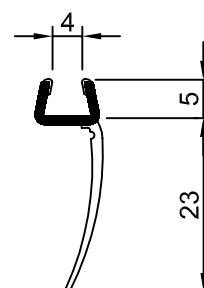

Art 655755

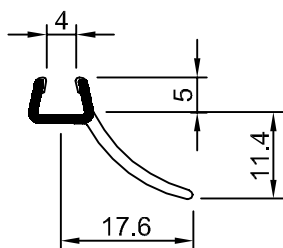

Art 655745

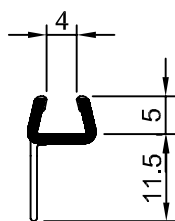

Art 655785

2.1.2 Profiles with 5 mm overlap for 6 mm thick glass

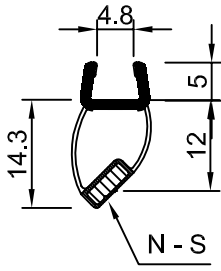

Art 656222
Magnetic strength 0.18 N/cm

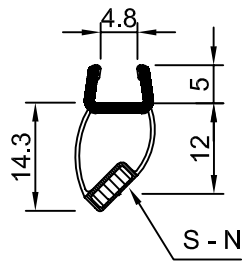

Art 656232
Magnetic strength 0.18 N/cm

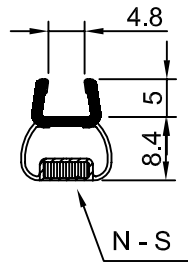

Art 656242
Magnetic strength 0.18 N/cm

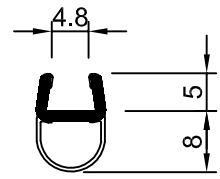

Art 656705

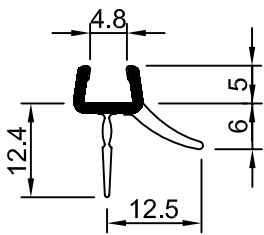

Art 656715

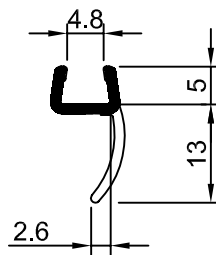

Art 656725

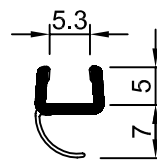

Art 656735

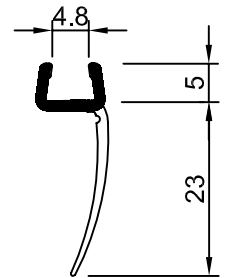

Art 656755

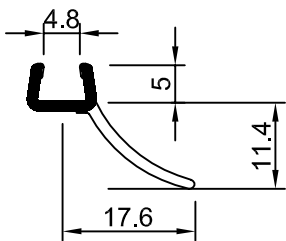

Art 656745

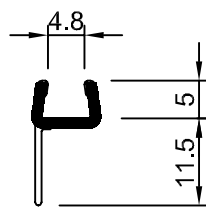

Art 656785

2.1.3 Profiles with 5 mm overlap for 8 mm thick glass

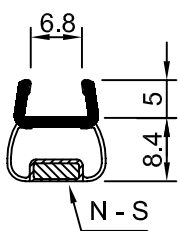

Art 653242
Magnetic strength 0.18 N/cm

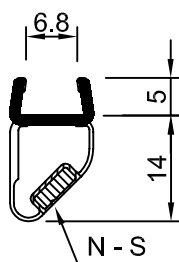

Art 653222
Magnetic strength 0.18 N/cm

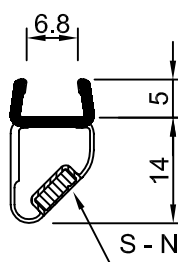

Art 653232
Magnetic strength 0.18 N/cm

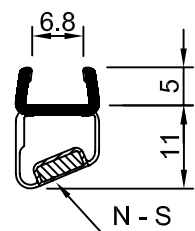

Art 653121
Magnetic strength 0.18 N/cm

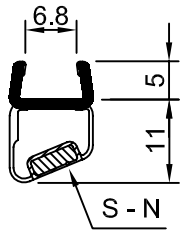

Art 653131
Magnetic strength 0,18 N/cm

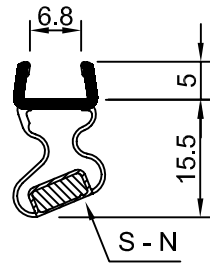

Art 653202
Magnetic strength 0,24 N/cm

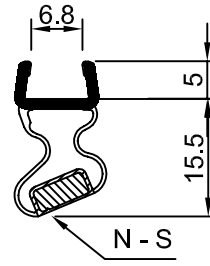

Art 653212
Magnetic strength 0,24 N/cm

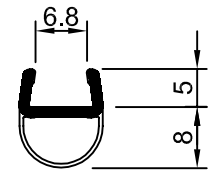

Art 653300

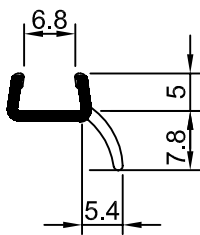

Art 653310

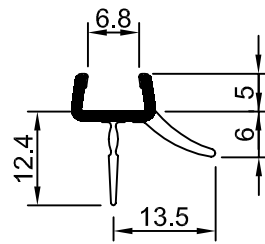

Art 653320

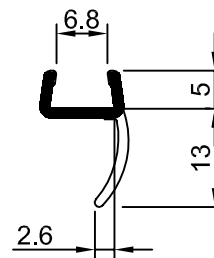

Art 653330

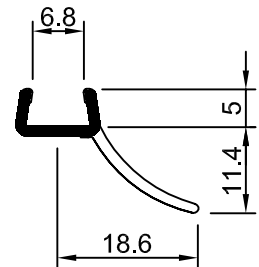

Art 653340

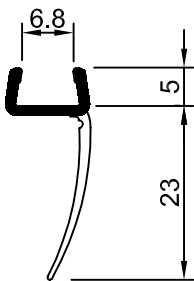

Art 653350

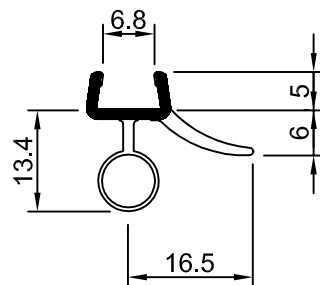

Art 653360

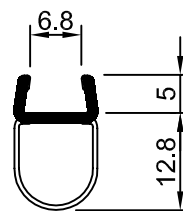

Art 653370

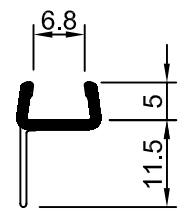

Art 653380

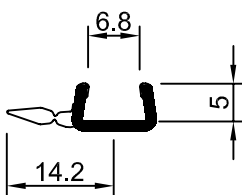

Art 653390

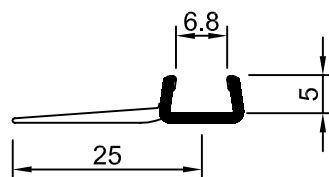

Art 653400

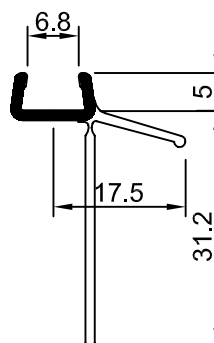

Art 653405

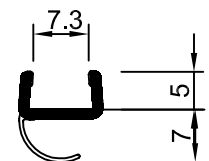

Art 653415

2.1.4 Profiles with 12 mm overlap for 5 mm thick glass

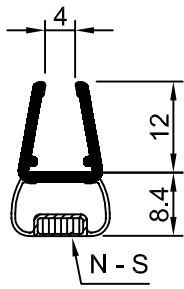

Art 654242
Magnetic strength 0.18 N/cm

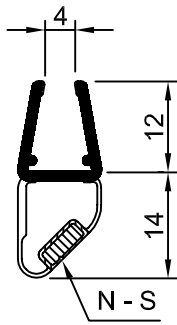

Art 654222
Magnetic strength 0.18 N/cm

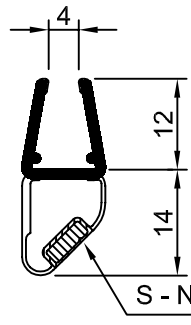

Art 654232
Magnetic strength 0.18 N/cm

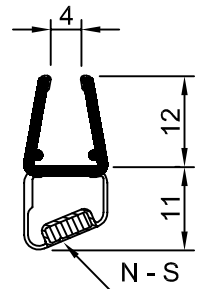

Art 654121
Magnetic strength 0.18 N/cm

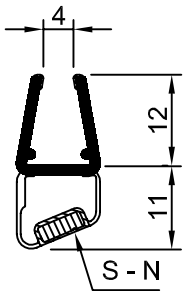

Art 654131
Magnetic strength 0.18 N/cm

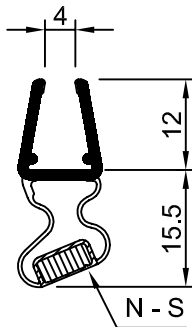

Art 654202
Magnetic strength 0.24 N/cm

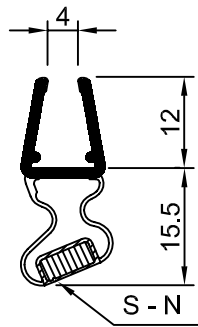

Art 654212
Magnetic strength 0.24 N/cm

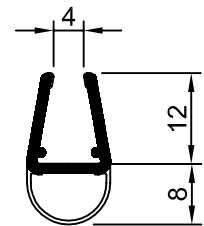

Art 654301

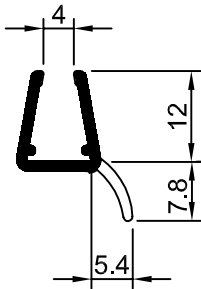

Art 654311

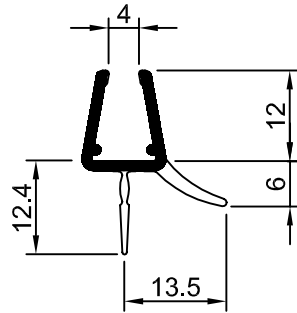

Art 654321

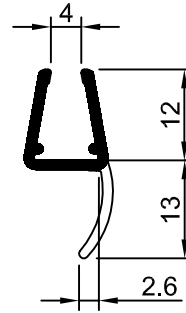

Art 654331

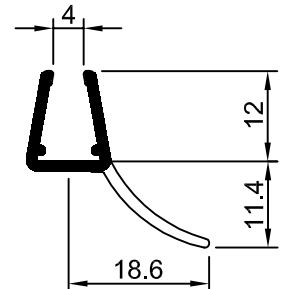

Art 654341

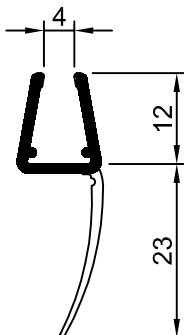

Art 654351

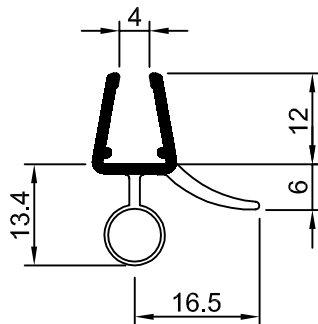

Art 654361

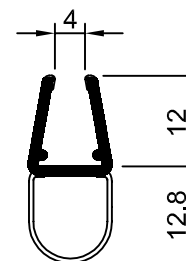

Art 654371

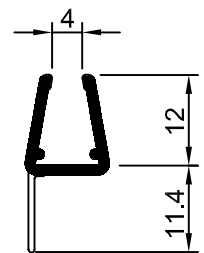

Art 654381

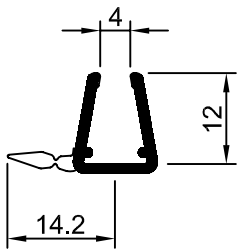

Art 654391

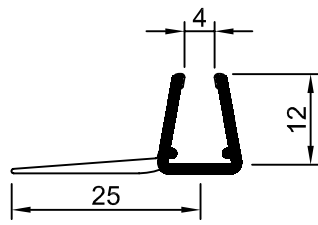

Art 654401

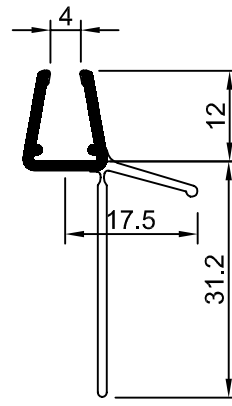

Art 654405

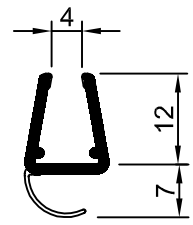

Art 654415

2.1.5 Profiles with 12 mm overlap for 6 and 8 mm thick glass

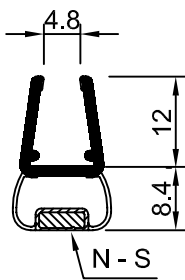

Art 652242
Magnetic strength 0.18 N/cm

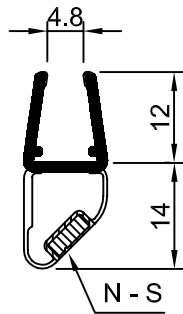

Art 652222
Magnetic strength 0.18 N/cm

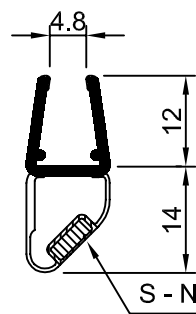

Art 652232
Magnetic strength 0.18 N/cm

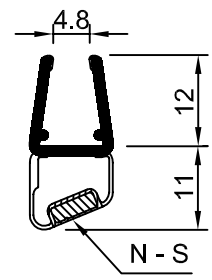

Art 652121
Magnetic strength 0.18 N/cm

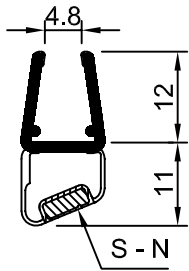

Art 652131
HMagnetic strength 0.18 N/cm

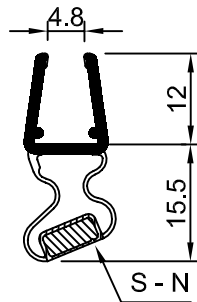

Art 652202
Magnetic strength 0.24 N/cm

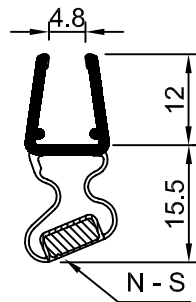

Art 652212
Magnetic strength 0.24 N/cm

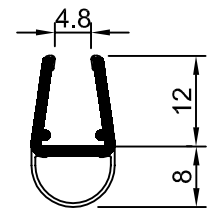

Art 652300

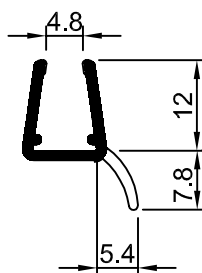

Art 652310

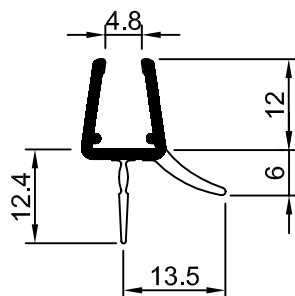

Art 652320

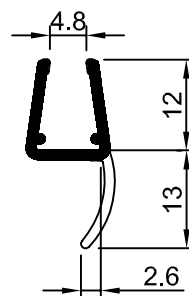

Art 652330

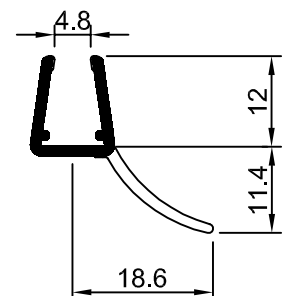

Art 652340

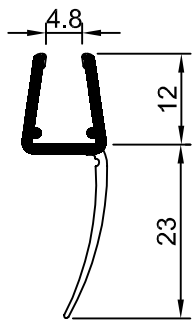

Art 652350

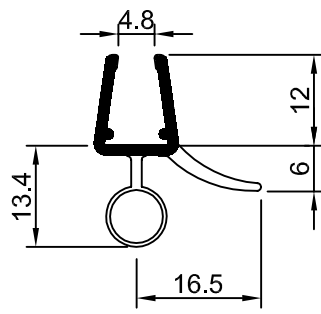

Art 652360

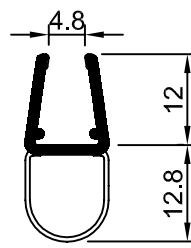

Art 652370

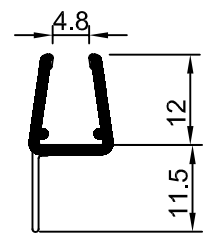

Art 652380

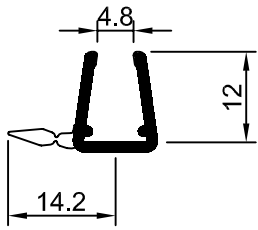

Art 652390

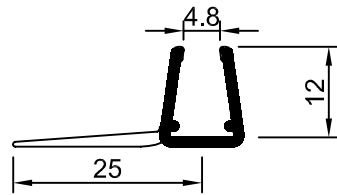

Art 652400

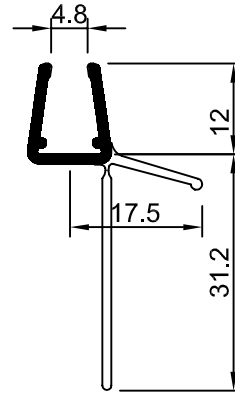

Art 652405

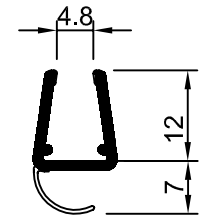

Art 652415



2.2 SEALING PROFILES IN RAU-PVC

USUAL TRANSPARENT COLOUR MATCHING (RIGID-PVC)

Rigid-PVC in transparent colour matching; soft PVC part with transparent textured or transparent clear surface, Shore A 75°, acrylic-resistant if necessary;

Door seal profiles with magnetic inlay: Magnet pockets in solid colour or transparent textured material, soft PVC flexible bellows in transparent clear or transparent textured material, magnet 2-pole

2.2.1 Profiles for 6 and 8 mm thick glass

addendum to the profiles in crystal clear colour matching pages 5-10

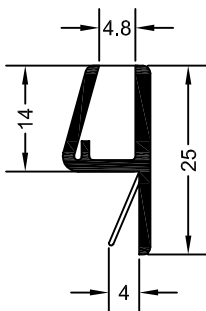

Art 636394

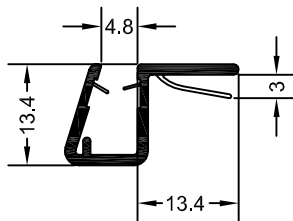

Art 632836

2.2.2 Profiles for 6 and 8 mm thick glass - chrome

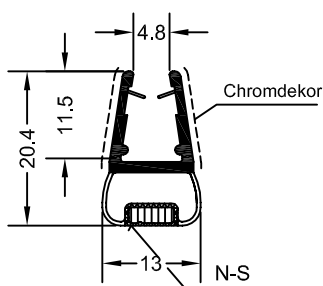

Art 651242
Magnetic strength 0.18 N/cm

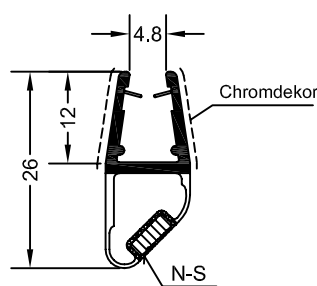

Art 651222
Magnetic strength 0.18 N/cm

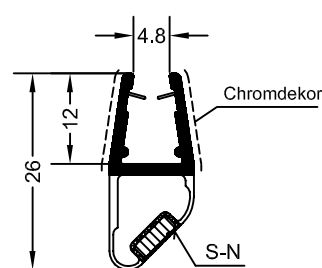

Art 651232
Magnetic strength 0.18 N/cm

2.2.3 Profiles for 8 and 10 mm thick glass

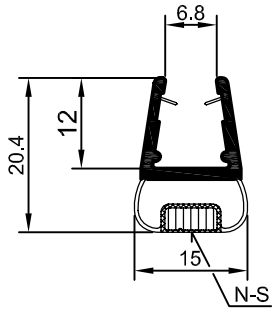

Art 650270
Magnetic strength 0.24 N/cm

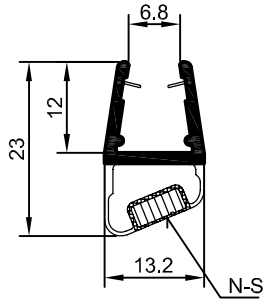

Art 650280
Magnetic strength 0.24 N/cm

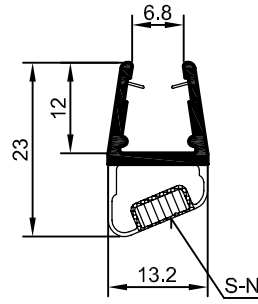

Art 650290
Magnetic strength 0.24 N/cm

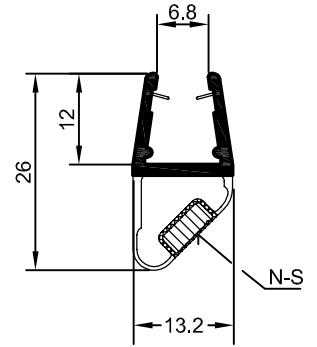

Art 650250
Magnetic strength 0.24 N/cm

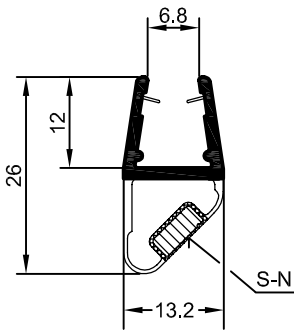

Art 650260
Magnetic strength 0.24 N/cm

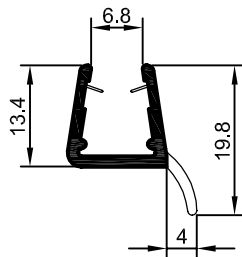

Art 650155

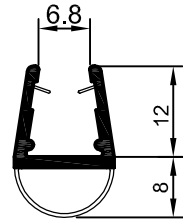

Art 650135

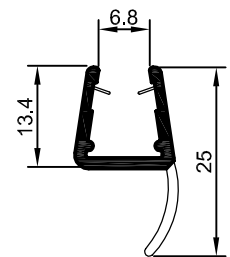

Art 650145

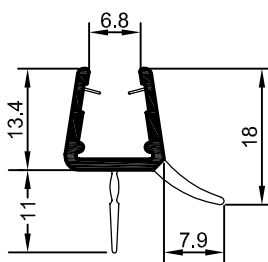

Art 650125

2.2.4 Profiles for other thicknesses

any glass thickness

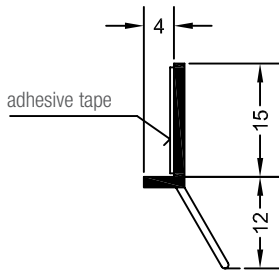

Art 632576

glass thickness 2 to 2,5 mm

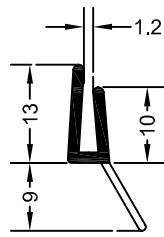

Art 632586

glass thickness 5 mm

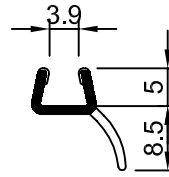

Art 639384

glass thickness 6 mm

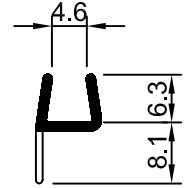

Art 650048

glass thickness 6 mm

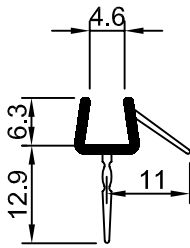

Art 650080

glass thickness 6 mm

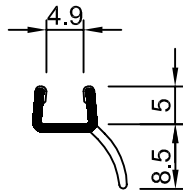

Art 639385

glass thickness 6 mm

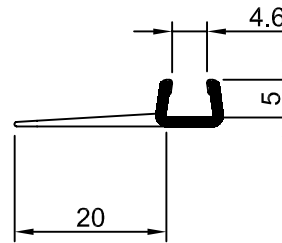

Art 626373

glass thickness 6 mm

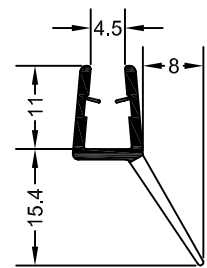

Art 633214

glass thickness 6 mm

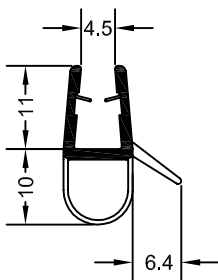

Art 633224

glass thickness 8 mm

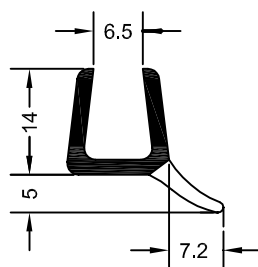

Art 636021

glass thickness 8 mm

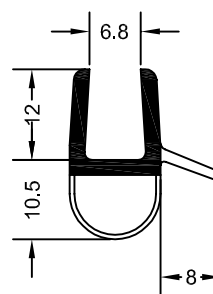

Art 600784

glass thickness 10 mm

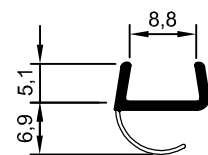

Art 650124

2.3 SLIDE-IN PROFILES

FOR INSERTION INTO ALUMINIUM STRIPS

2.3.1 in RAU-PVC

in soft RAU-PVC, Shore-A 80, soft colouring

N-S: 2-pole magnetised surface, north-south
in rigid/soft RAU-PVC, Shore-A 80, soft colouring

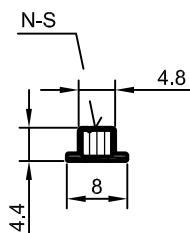

Art 650084
Magnetic strength 0.11 N/cm

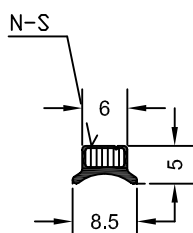

Art 650039
Magnetic strength 0.13 N/cm

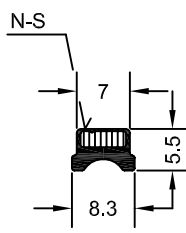

Art 632816
Magnetic strength 0.18 N/cm

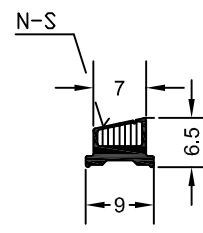

Art 636167
Magnetic strength 0.17 N/cm

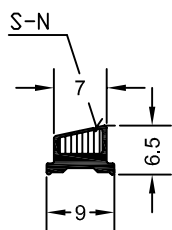

Art 650030
Magnetic strength 0.17 N/cm

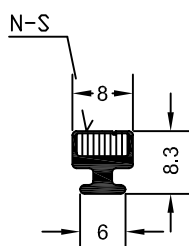

Art 650040
Magnetic strength 0.24 N/cm

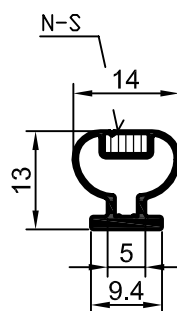

Art 650081
Magnetic strength 0.25 N/cm

2.3.2 in RAU-SRT

in rigid/soft RAU-PVC, Shore-A 75, soft colouring

Shore-A 70, soft colouring

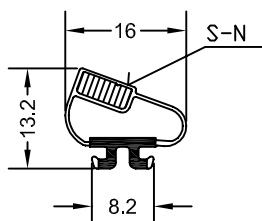

Art 637978
Magnetic strength 0.24 N/cm

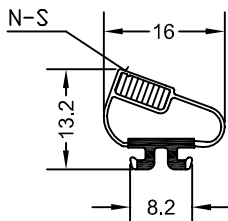

Art 637988
Magnetic strength 0.24 N/cm

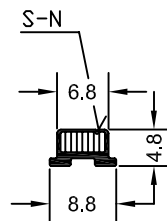

Art 650014
Magnetic strength 0.12 N/cm

2.4 GLAZING PROFILES

2.4.1 in RAU-PVC / RAU-PE

Soft RAU-PVC, Shore-A 76;
transparent

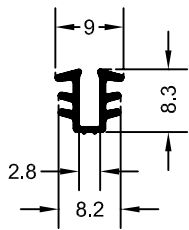

Art 601712

Soft RAU-PE, Shore-A 93;
transparent

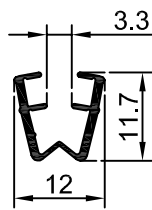

Art 650021

Rigid/soft RAU-PVC, transparent, Soft PVC part Shore-A 70

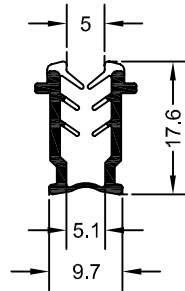

Art 615003

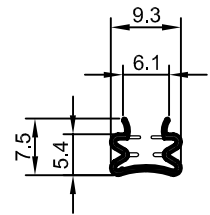

Art 650023

2.4.2 in RAU-SIK

Shore-A 75; with anti-stretch element (soft colouring if required)

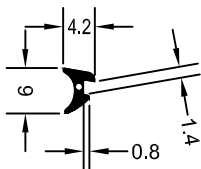

Art 834681

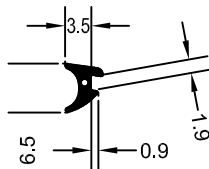

Art 835801

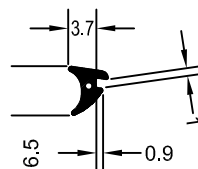

Art 835821

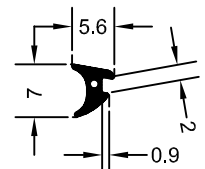

Art 835721

2.5 MAGNETIC PROFILES IN RAU-FER

2.5.1 Magnetic strips

N-S: 2-pole magnetised surface, north-south

Colour: black-brown

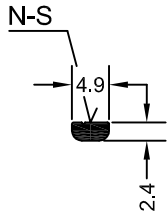

Art 650004
Magnetic strength 0.12 N/cm

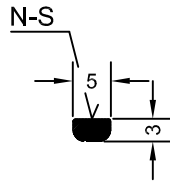

Art 622082
Magnetic strength 0.14 N/cm

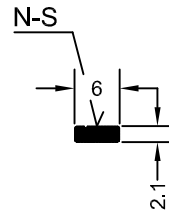

Art 604943
Magnetic strength 0.09 N/cm
Art 638423
Magnetic strength 0.13 N/cm
Art 600064
Magnetic strength 0.18 N/cm

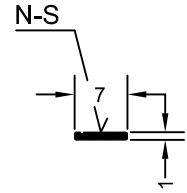

Art 632812
Magnetic strength 0.09 N/cm

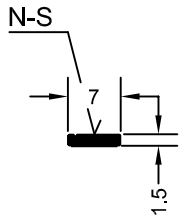

Art 606063
Magnetic strength 0.13 N/cm

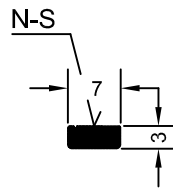

Art 600269
Magnetic strength 0.24 N/cm

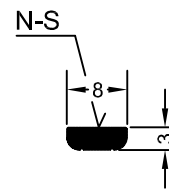

Art 629990
Magnetic strength 0.26 N/cm

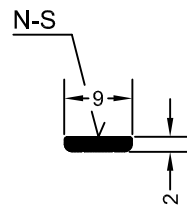

Art 600258
Magnetic strength 0.13 N/cm

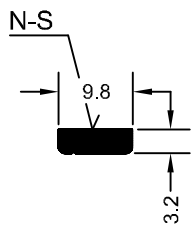

Art 632423
Magnetic strength 0.36 N/cm

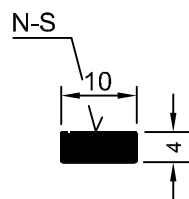

Art 625468
Magnetic strength 0.39 N/cm

2.5.2 Coated magnetic strips

in RAU-PVC, Shore-A 75, soft colouring

N-S: 2-pole magnetised surface, north-south

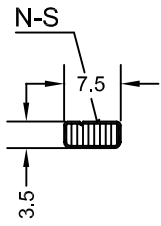

Art 650193
Magnetic strength 0.24 N/cm

2.5.3 Magnetic strips with self-adhesive strip

N-S: 2-pole magnetised surface, north-south

N-S-N-S: 4-pole magnetised surface north-south-north-south

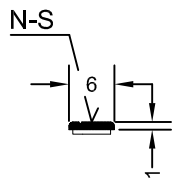

Art 626502
Magnetic strength 0.06 N/cm

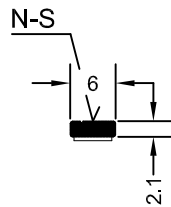

Art 604983
Magnetic strength 0.09 N/cm

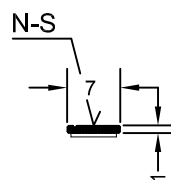

Art 636967
Magnetic strength 0.06 N/cm

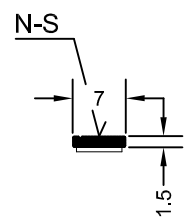

Art 627552
Magnetic strength 0.13 N/cm

Art 626692
Magnetic strength 0.09 N/cm

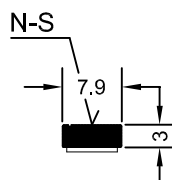

Art 606983
Magnetic strength 0.28 N/cm

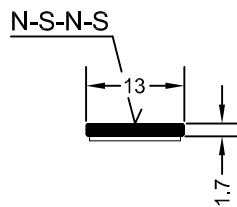

Art 601627
Magnetic strength 0.18 N/cm

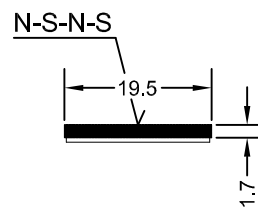

Art 631301
Magnetic strength 0.51 N/cm

2.5.4 T-magnets

N-S: 2-pole magnetised surface, north-south

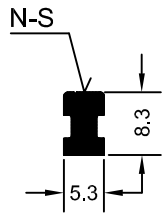

Art 630472
Magnetic strength 0.09 N/cm

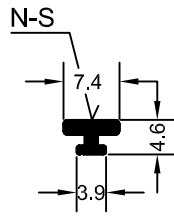

Art 637975
Magnetic strength 0.12 N/cm

2.5.5 Hat magnets

N-S: 2-pole magnetised surface, north-south

N-S-N: 3-pole magnetised surface, north-south-north

S-N-S: 3-pole magnetised surface, 3-pole south-north-south

S-N-S-N: 4-pole magnetised surface, south-north-south-north

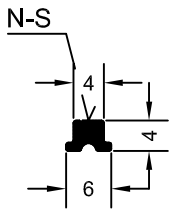

Art 606663
Magnetic strength 0.09 N/cm

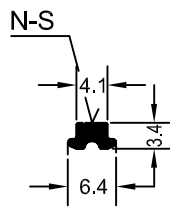

Art 632832
Magnetic strength 0.12 N/cm

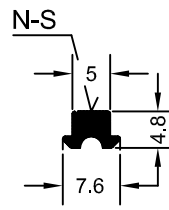

Art 629562
Magnetic strength 0.18 N/cm

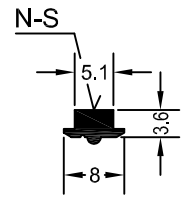

Art 618214
Magnetic strength 0.18 N/cm

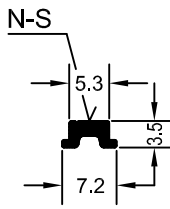

Art 639422
Magnetic strength 0.09 N/cm

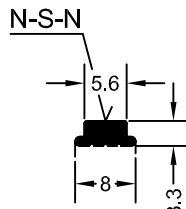

Art 634093
Magnetic strength 0.13 N/cm

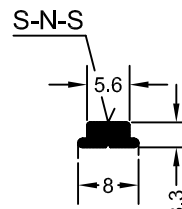

Art 634083
Magnetic strength 0.13 N/cm

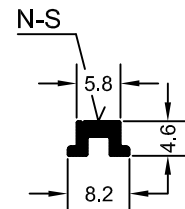

Art 636153
Magnetic strength 0.12 N/cm

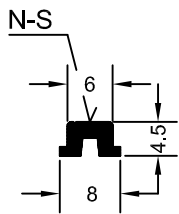

Art 630452
Magnetic strength 0.11 N/cm
Art 626892
Magnetic strength 0.16 N/cm

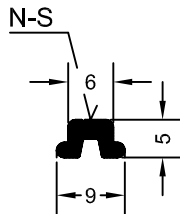

Art 628632
Magnetic strength 0.10 N/cm
Art 603414
Magnetic strength 0.20 N/cm

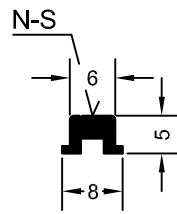

Art 626312
Magnetic strength 0.15 N/cm

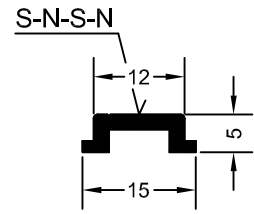

Art 625982
Magnetic strength 0.13 N/cm

2.5.6 Stepped magnets

N-S: 2-pole magnetised surface, north-south

S-N: 2-pole magnetised surface, south-north

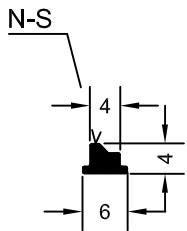

Art 636114
Magnetic strength 0.17 N/cm
Art 600744
Magnetic strength 0.20 N/cm

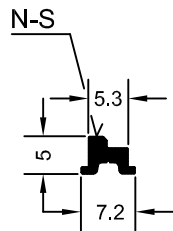

Art 637545
Magnetic strength 0.26 N/cm

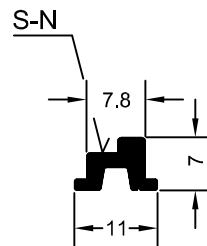

Art 636233
Magnetic strength 0.17 N/cm

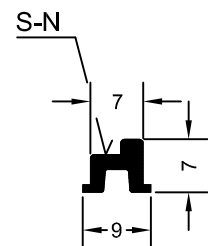

Art 627852
Magnetic strength 0.16 N/cm

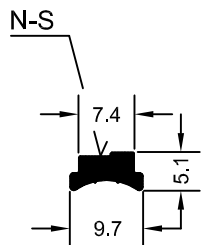

Art 633915
Magnetic strength 0.15 N/cm
Art 639073
Magnetic strength 0.32 N/cm

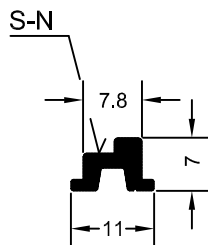

Art 634403
Magnetic strength 0.16 N/cm

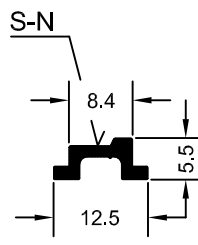

Art 602094
Magnetic strength 0.24 N/cm

2.5.7 Special magnetic profiles

N-S: 2-pole magnetised surface, north-south

S-N: 2-pole magnetised surface, south-north

N-S-N-S: 4-pole magnetised surface, north-south-north-south

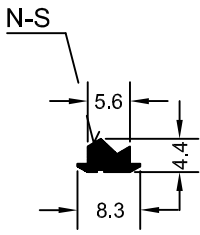

Art 611833
Magnetic strength 0.13 N/cm

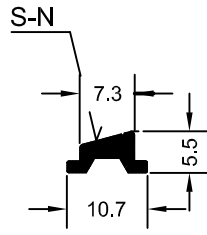

Art 633265
Magnetic strength 0.13 N/cm

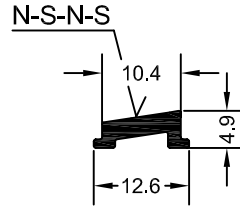

Art 618433
Magnetic strength 0.20 N/cm



2.6 OTHER PROFILES

2.6.1 Adapter profiles

soft, transparent, acrylicresistant,
Shore-A 75 (intake reduction reference to 6-8 mm glass)

for beveled glass

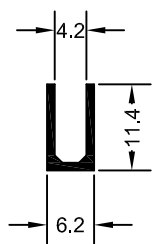

Art 650065

for unbeveled glass

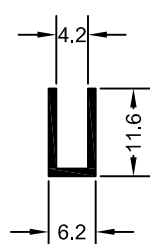

Art 650055

2.6.2 Strip seals in RAU-PVC

rigid/soft, transparent, with polyurthane hinge,
for clipping onto aluminium profiles

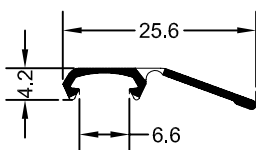

Art 632783

2.6.3 Door seal profiles for insertion in aluminium strips

in RAU-PVC

Shore-A 75,
transparent or soft colouring

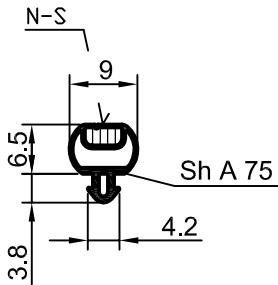

Art 650066
Magnetic strength 0.12 N/cm

Shore-A 77;
Soft colouring in conjunction
with magnetic strips

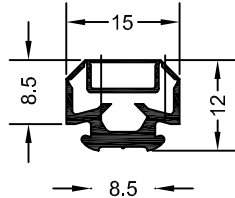

Art 608992
Magnet: 2-pole
Art. 629990
Magnetic strength 0.26 N/cm

in RAU-SIK

Shore-A 75;
soft colouring

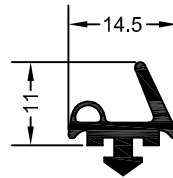

Art 835261

N-S: 2-pole magnetised surface, north-south

2.6.4 Sealing profiles in RAU-SIK

transparent, Shore-A 60 (soft colouring if required)

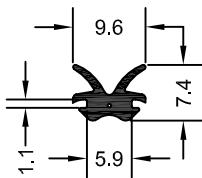

Art 834571

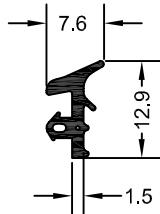

Art 834561

2.6.5 Hinge profiles in RAU-PVC

soft colouring, soft PVC part Shore-A 70

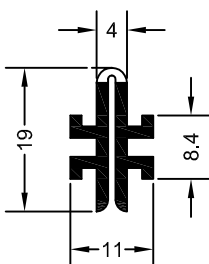

Art 633154

2.6.6 Shock damping profiles in RAU-PVC / RAU-SB / RAU-SRT

Soft RAU-PVC, Shore-A 76;
transparent

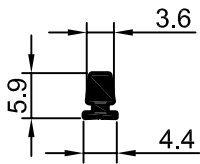

Art 633845

Rigid/soft RAU-PVC,
transparent,
Soft PVC part Shore-A 60

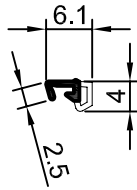

Art 636304

Rigid/soft RAU-SB/SRT,
transparent,
Soft part Shore-A 62

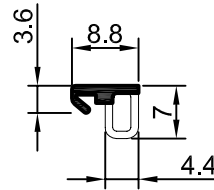

Art 650132

2.6.7 Cover profiles

in RAU-rigid PVC

soft colouring

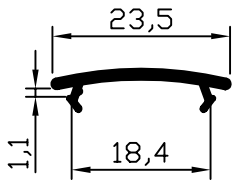

Art 636407

soft colouring
mit Magnet

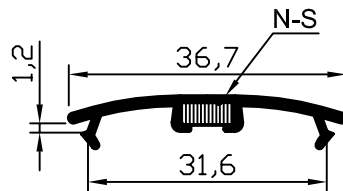

Art 636397
Magnetic strength 0.24 N/cm

in RAU-rigid/soft PVC

soft colouring, soft PVC part Shore-A 70

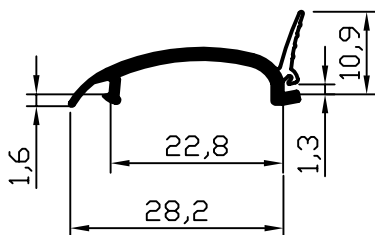

Art 633234

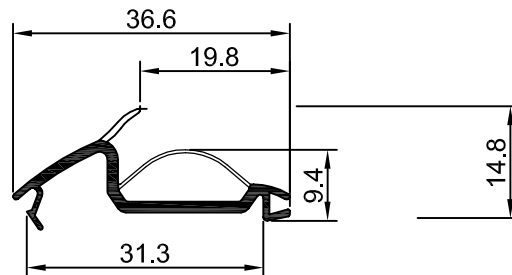

Art 650024

3 LIST OF ARTICLES

Article-No.	Page	Article description	Magnetic profiles Magnetic strength in N/cm	Sealing profiles with overlap		Sealing profiles for glass thicknesses			
				5 mm	12mm	Sonst.	5mm	6mm	8mm
600064	16	Magnetic strip	0.18						
600258	16	Magnetic strip	0.13						
600269	16	Magnetic strip	0.24						
600744	19	Stepped magnet	0.20						
600784	13	Sealing profile			X				X
601627	17	Magnetic strip with self-adhesive strip	0.18						
601712	15	Glazing profile in RAU-PVC				X			
602094	19	Stepped magnet	0.24						
603414	19	Hat magnet	0.20						
604943	16	Magnetic strip	0.09						
604983	17	Magnetic strip with self-adhesive strip	0.09						
606063	16	Magnetic strip	0.13						
606663	18	Hat magnet	0.09						
606983	17	Magnetic strip with self-adhesive strip	0.28						
608992	22	Door seal profile							
611833	20	Special magnetic profile	0.13						
615003	15	Glazing profile in RAU-PVC				X			
618214	18	Hat magnet	0.18						
618433	20	Special magnetic profile	0.20						
622082	16	Magnetic strip	0.14						
625468	16	Magnetic strip	0.39						
625982	19	Hat magnet	0.13						
626312	19	Hat magnet	0.15						
626373	13	Sealing profile		X				X	
626502	17	Magnetic strip with self-adhesive strip	0.06						
626692	17	Magnetic strip with self-adhesive strip	0.09						
626892	19	Hat magnet	0.16						
627552	17	Magnetic strip with self-adhesive strip	0.13						
627852	19	Stepped magnet	0.16						
628632	19	Hat magnet	0.10						
629562	18	Hat magnet	0.18						
629990	16/22	Magnetic strip	0.26						
630452	19	Hat magnet	0.11						
630472	18	T-magnet	0.09						
631301	17	Magnetic strip with self-adhesive strip	0.51						
632423	16	Magnetic strip	0.36						
632576	13	Magnetic strip with self-adhesive strip				X	X	X	X
632586	13	Sealing profile			X	X			
632783	21	Strip seal							
632812	16	Magnetic strip	0.09						
632816	14	Profile with magnetic inlay	0.18						
632832	18	Hat magnet	0.12						

Article-No.	Page	Article description	Magnetic profiles Magnetic strength in N/cm	Sealing profiles with overlap		Sealing profiles for glass thicknesses			
				5 mm	12mm	Sonst.	5mm	6mm	8mm
632836	11	Sealing profile			X			X	X
633154	22	Hinge profile							
633214	13	Sealing profile			X			X	
633224	13	Sealing profile			X			X	
633234	23	Cover profile							
633265	20	Special magnetic profile	0.13						
633845	23	Shock damping profile							
633915	19	Stepped magnet	0.15						
634083	18	Hat magnet	0.13						
634093	18	Hat magnet	0.13						
634403	19	Stepped magnet	0.16						
636021	13	Sealing profile			X				X
636114	19	Stepped magnet	0.17						
636153	18	Hat magnet	0.12						
636167	14	Profile with magnetic inlay	0.17						
636233	19	Stepped magnet	0.17						
636304	23	Shock damping profile							
636394	11	Sealing profile			X			X	X
636397	23	Cover profile							
636407	23	Cover profile							
636967	17	Magnetic strip with self-adhesive strip	0.06						
637545	19	Stepped magnet	0.26						
637975	18	T-magnet	0.12						
637978	14	Profile with magnetic inlay	0.24						
637988	14	Profile with magnetic inlay	0.24						
638423	16	Magnetic strip	0.13						
639073	19	Stepped magnet	0.32						
639384	13	Sealing profile		X			X		
639385	13	Sealing profile		X				X	
639422	18	Hat magnet	0.09						
650004	16	Magnetic strip	0.12						
650014	14	Profile with magnetic inlay	0.12						
650021	15	Glazing profile in RAU-PE				X			
650023	15	Glazing profile in RAU-PVC				X			
650024	23	Cover profile							
650030	14	Profile with magnetic inlay	0.17						
650039	14	Profile with magnetic inlay	0.13						
650040	14	Profile with magnetic inlay	0.24						
650048	13	Sealing profile		X				X	
650055	21	Adapter profile				X			
650065	21	Adapter profile				X			
650066	22	Magnetic door seal	0.12						
650080	13	Sealing profile		X				X	
650081	14	Profile with magnetic inlay	0.25						
650084	14	Profile with magnetic inlay	0.11						
650124	13	Sealing profile		X		X			
650125	12	Sealing profile			X	X			X
650132	23	Shock damping profile							
650135	12	Sealing profile			X	X			X
650145	12	Sealing profile			X	X			X
650155	12	Sealing profile			X	X			X

Article-No.	Page	Article description	Magnetic profiles Magnetic strength in N/cm	Sealing profiles with overlap		Sealing profiles for glass thicknesses		
				5 mm	12mm	Sonst.	5mm	6mm
650193	17	Profile with magnetic inlay	0.24					
650250	12	45° magnetic door seal profile, N-S	0.24		X	X		X
650260	12	45° magnetic door seal profile, S-N	0.24		X	X		X
650270	12	180° magnetic door seal profile	0.24		X	X		X
650280	12	135° magnetic door seal profile, N-S	0.24		X	X		X
650290	12	135° magnetic door seal profile, S-N	0.24		X	X		X
651222	11	45° magnetic door seal profile, chrome, N-S	0.18		X		X	X
651232	11	45° magnetic door seal profile, chrome, S-N	0.18		X		X	X
651242	11	180° magnetic door seal profile, chrome	0.18		X		X	X
652121	9	135° magnetic door seal profile, N-S	0.18		X		X	X
652131	9	135° magnetic door seal profile, S-N	0.18		X		X	X
652202	9	Magnetic door seal profile, N-S	0.24		X		X	X
652212	9	Magnetic door seal profile, S-N	0.24		X		X	X
652222	9	45° magnetic door seal profile, N-S	0.18		X		X	X
652232	9	45° magnetic door seal profile, S-N	0.18		X		X	X
652242	9	180° magnetic door seal profile	0.18		X		X	X
652300	9	Sealing profile			X		X	X
652310	9	Sealing profile			X		X	X
652320	9	Sealing profile			X		X	X
652330	9	Sealing profile			X		X	X
652340	9	Sealing profile			X		X	X
652350	10	Sealing profile			X		X	X
652360	10	Sealing profile			X		X	X
652370	10	Sealing profile			X		X	X
652380	10	Sealing profile			X		X	X
652390	10	Sealing profile			X		X	X
652400	10	Sealing profile			X		X	X
652405	10	Sealing profile			X		X	X
652415	10	Sealing profile			X		X	X
653121	6	135° magnetic door seal profile, N-S	0.18	X				X
653131	7	135° magnetic door seal profile, S-N	0.18	X				X
653202	7	Magnetic door seal profile, N-S	0.24	X				X
653212	7	Magnetic door seal profile, S-N	0.24	X				X
653222	6	45° magnetic door seal profile, N-S	0.18	X				X
653232	6	45° magnetic door seal profile, S-N	0.18	X				X
653242	6	180° magnetic door seal profile	0.18	X				X
653300	7	Sealing profile		X				X
653310	7	Sealing profile		X				X
653320	7	Sealing profile		X				X
653330	7	Sealing profile		X				X
653340	7	Sealing profile		X				X
653350	7	Sealing profile		X				X
653360	7	Sealing profile		X				X
653370	7	Sealing profile		X				X
653380	7	Sealing profile		X				X
653390	7	Sealing profile		X				X
653400	7	Sealing profile		X				X
653405	7	Sealing profile		X				X
653415	7	Sealing profile		X				X
654121	8	135° magnetic door seal profile, N-S	0.18		X		X	
654131	8	135° magnetic door seal profile, S-N	0.18		X		X	

Article-No.	Page	Article description	Magnetic profiles Magnetic strength in N/cm	Sealing profiles with overlap		Sealing profiles for glass thicknesses			
				5 mm	12mm	Sonst.	5mm	6mm	8mm
654202	8	Magnetic door seal profile, N-S	0.24		X		X		
654212	8	Magnetic door seal profile, S-N	0.24		X		X		
654222	8	45° magnetic door seal profile, N-S	0.18		X		X		
654232	8	45° magnetic door seal profile, S-N	0.18		X		X		
654242	8	180° magnetic door seal profile	0.18		X		X		
654301	8	Sealing profile			X		X		
654311	8	Sealing profile			X		X		
654321	8	Sealing profile			X		X		
654331	8	Sealing profile			X		X		
654341	8	Sealing profile			X		X		
654351	8	Sealing profile			X		X		
654361	8	Sealing profile			X		X		
654371	8	Sealing profile			X		X		
654381	8	Sealing profile			X		X		
654391	9	Sealing profile			X		X		
654401	9	Sealing profile			X		X		
654405	9	Sealing profile			X		X		
654415	9	Sealing profile			X		X		
655222	5	45° magnetic door seal profile, N-S	0.18	X			X		
655232	5	45° magnetic door seal profile, S-N	0.18	X			X		
655242	5	180° magnetic door seal profile	0.18	X			X		
655705	5	Sealing profile		X			X		
655715	5	Sealing profile		X			X		
655725	5	Sealing profile		X			X		
655735	5	Sealing profile		X			X		
655745	5	Sealing profile		X			X		
655755	5	Sealing profile		X			X		
655785	5	Sealing profile		X			X		
656222	6	45° magnetic door seal profile, N-S	0.18	X				X	
656232	6	45° magnetic door seal profile, S-N	0.18	X				X	
656242	6	180° magnetic door seal profile	0.18	X				X	
656705	6	Sealing profile		X				X	
656715	6	Sealing profile		X				X	
656725	6	Sealing profile		X				X	
656735	6	Sealing profile		X				X	
656745	6	Sealing profile		X				X	
656755	6	Sealing profile		X				X	
656785	6	Sealing profile		X				X	
834561	22	Silicone profile RAU-SIK							
834571	22	Silicone profile RAU-SIK							
834681	15	Silicone glazing profile RAU-SIK							
835261	22	Door seal profile RAU-SIK							
835721	15	Silicone glazing profile RAU-SIK							
835801	15	Silicone glazing profile RAU-SIK							
835821	15	Silicone glazing profile RAU-SIK							

This document is protected by copyright. All rights based on this are reserved. No part of this publication may be translated, reproduced or transmitted in any form or by any similar means, electronic or mechanical, photocopying, recording or otherwise, or stored in a data retrieval system.

The dimensions shown in this leaflet are approximate. In regard to tolerances, our Conditions of Sale apply exclusively.

We therefore recommend that you verify the suitability for your intended purpose of designs contained in this leaflet. The methods of application, utilization and processing of our products are outside our control and are therefore exclusively your responsibility. Our warranty covers consistency of quality of our products in accordance with our specification, as laid down in our recognized Conditions of Sale. Where there is any question of liability, any compensation shall be limited to the value of the goods supplied by us and used by you.